





KOKKUPANEKUJUHEND

TOOL HAYDIE 20397

TÄHELEPANU!

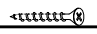
* Asetage kõik puidust osad puhtale, tasasele aluspinnale (näiteks vaibale). Vältige osade kahjustamist töö käigus.

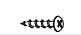
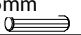
* Enne töö alustamist tutvuge juhendiga. Ärge keerke kruvisid ja polte lõpuni kinni enne, kui kogu tool on kokku pandud.

KINNITUSTARVIKUTE LOETELU		OSADE LOETELU	
A	JCBC M6 x 70mm + S/W M6 + F/W M6 x 13mm 	4tk	1 Seljatugi 1tk
B	FH Kruvi M838mm 	4tk	2 Istme külg V/P 2tk
C	L-klamber 	4tk	3 Küljepõõn 2tk
D	PH Kruvi M4x12mm 	8tk	4 Eesmine jalg 1tk
E	Puidust tüübel M8x25mm 	2tk	5 Iste 1tk
F	Võti M4 	1tk	

ETTEVAATUST!

Ärge keerake kruvisid ja polte lõpuni kinni enne, kui kogu tool on kokku pandud.

Ärge keerake polte liiga kõvasti kinni. Puit võib lõheneda.

Hoidke kinnitustarvikud töö ajal lastele kättesaamatus kohas.

SAMM 1

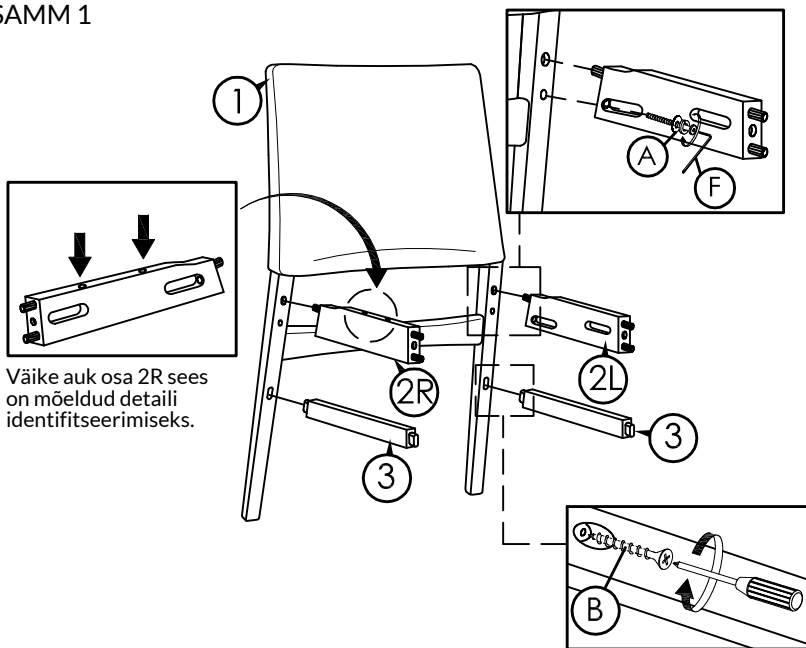

SAMM 2

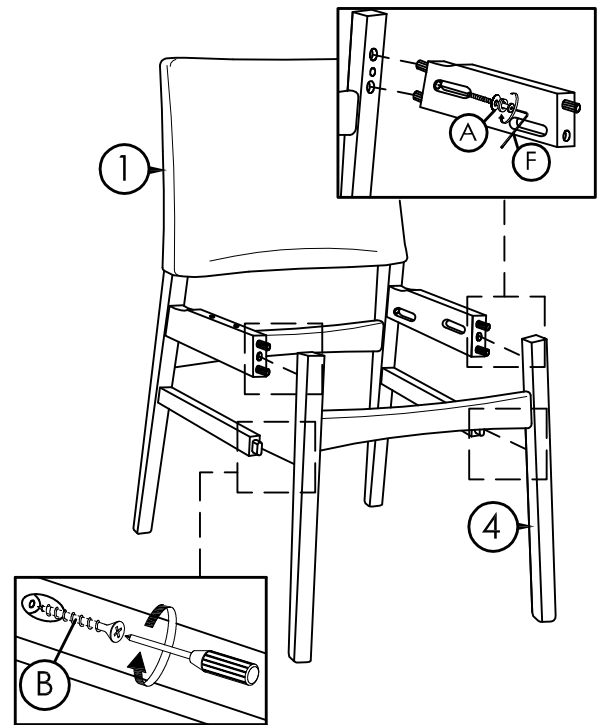

SAMM 3

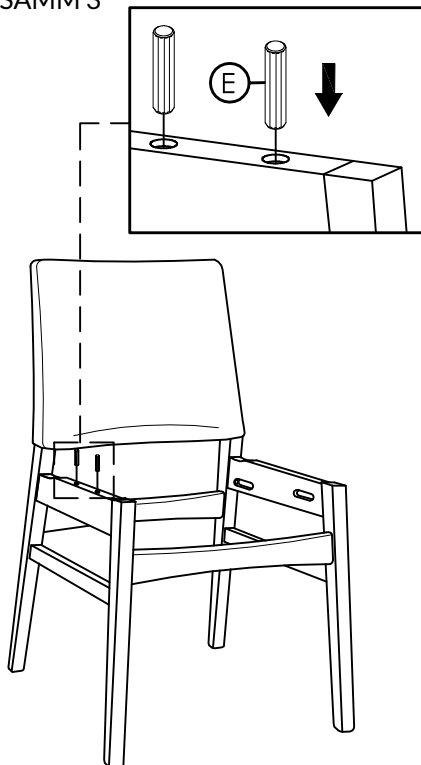

SAMM 4

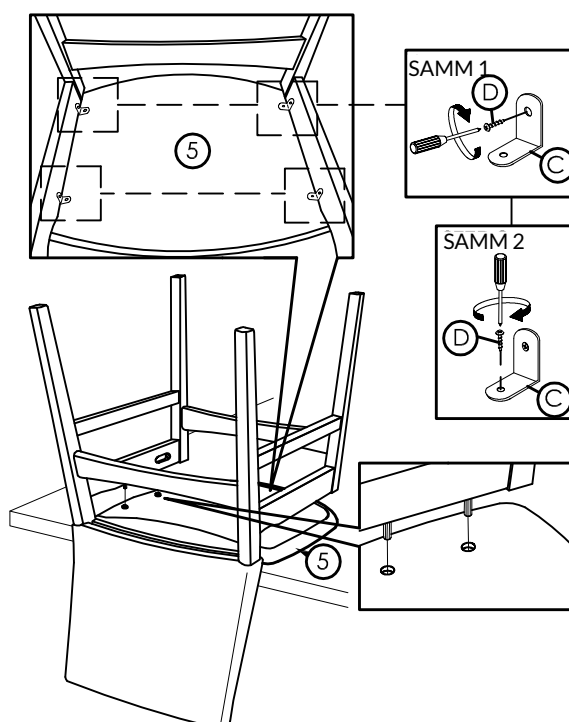

SAMM 5

